



**JSI**  
**INFRA**  
**DEVELOPERS**





**Building  
Dreams,  
Crafting  
Tomorrow**

# About Us

**JSI Infra Developer has been one of the most dynamic and innovative real estate developers in Lucknow, India. Company was founded with a motto 'Real Cost of Value'. In this business, our centric approach has been instrumental in the company's growth.**

Transparency in our operations, being one of our biggest assets, has been extremely effective in achieving highest levels of customer satisfaction.

## Progress

Our progress has been based on strong ethical values, high standards of quality, environmental and regulatory compliance and above all strong management.

## Experience

We have a judicious mix of youth and experience in our team along with a clear focus to nurture talent and promote innate potential of our employees.

### Mission

To build a legacy of trust and excellence by developing high-quality infrastructure that enhances the living standards.

### Vision

To be the leading real estate developer in Lucknow, recognized for our contribution to transforming the cityscape.

### Path

To create integrated townships and lifestyle patterns that provides more than just spaces to live and operate out of.



# Our Projects

## Aalishan City

**At JSI Infra Developers, we take pride in our diverse portfolio of projects that are not just structures but landmarks of Lucknow. Each project is a testament to our commitment to quality, luxury, and thoughtful design.**

Explore our three ongoing projects in Lucknow, the capital city of Uttar Pradesh, which is emerging as a promising destination for real estate investment, in the light of the developments that are turning this city of nawabs into a modern smart city.

## Awadh Express City



## Prime Green City

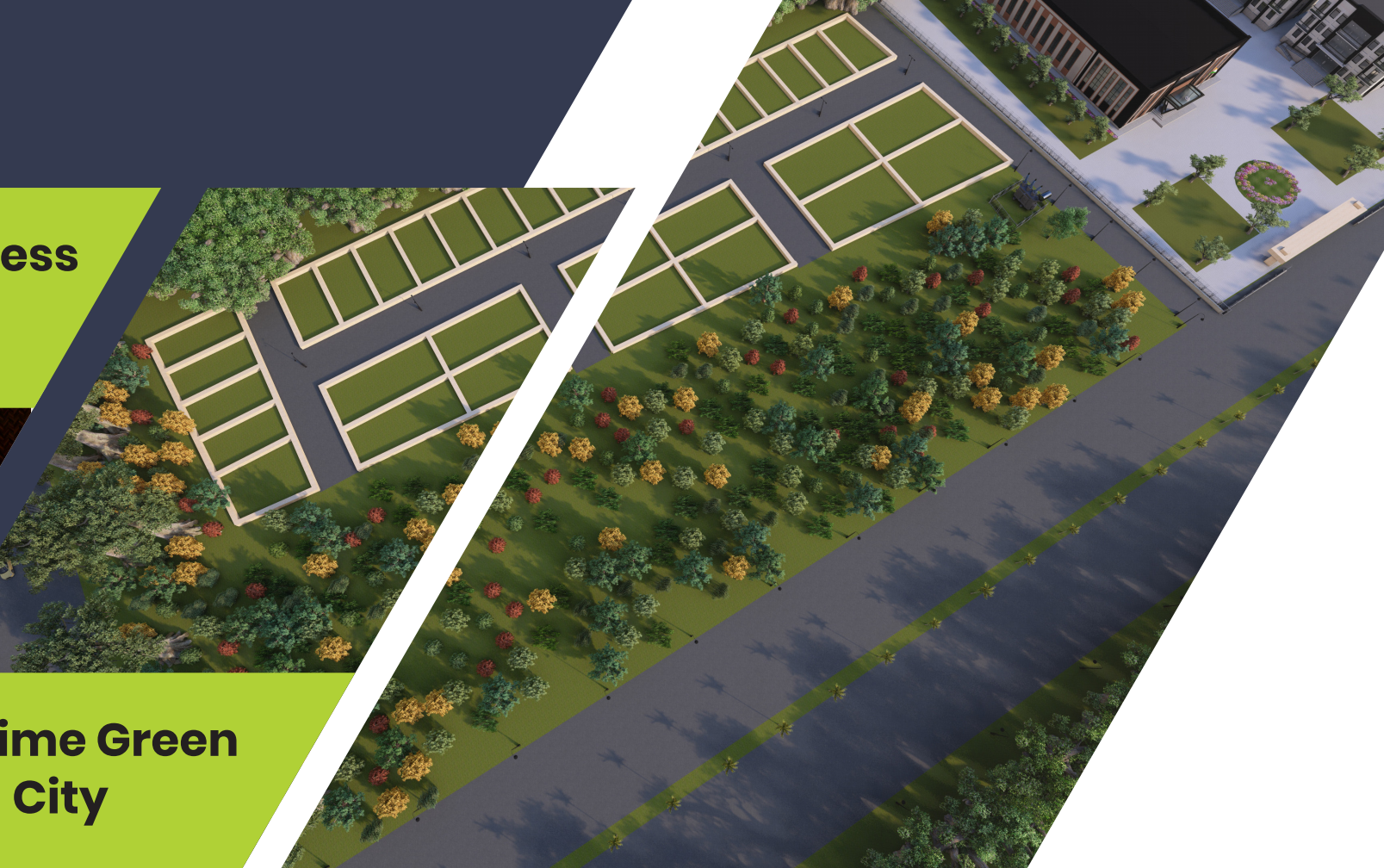

## The City of Nawabs





# Aalishan City



## Overview

The excellent Plots and Row Houses are available for sale in one of the most sought-after and most preferred areas Gokul Gram Yojna, Para, Alambagh, Lucknow. Extended in the vast area of various sizes of Plots & Row Houses are equipped with an array of necessary and modern facilities. Enjoy the unique living experience that the Aalishan City offers you in Lucknow.

### Aminities



**Park & Jogging Track**



**Street Lights & Wide Roads**



**Transformer**



**CCTV Cameras**





### Location Advantages

- 0.5 km. from Seth Anandram Jaipuriya School & Sports Galaxy
- 6.0 km. from Krishna Nagar Metro Station
- 2.0 km. from Agra Express Way
- 9.5 km. from Charbagh Railway Station
- 7.0 km. from Alambagh Bus Station
- 4.5 km. from Manak Nagar Railway Station
- 10.0 km. from Amausi Airport
- 5.2 km. from Pheonix United Mall
- 5.0 km. from Awadh Hospital
- 5.2 km. from Apollomedics Hospital, Lucknow
- 10.5 km. from Cantonment



# Awadh Express City



## Overview

Awadh Express City is an emblem of modernity and prosperity, strategically located near the Agra-Lucknow Expressway in the vibrant city of Lucknow. This ambitious project by JSI Infra Developers offers a unique blend of residential and commercial plots, designed to cater to your aspirations for a dream home or a thriving business.

### Aminities



01

**Shops**



02

**Street Lights**



03

**Wide Roads**



04

**CCTV Cameras**

## Birds Eye View

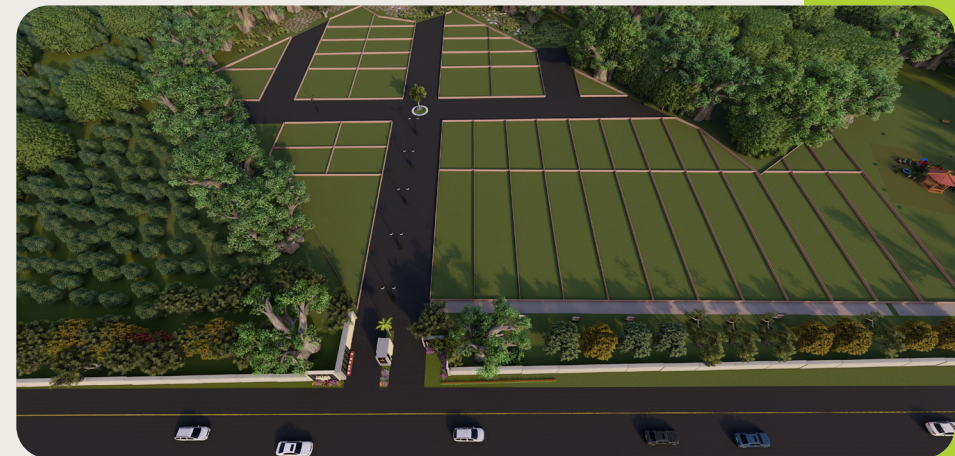



# AWADH EXPRESS CITY



## Residential Plots:

Discover the joy of building your own home in a community that promises a balanced lifestyle with access to all the modern amenities. Choose from a variety of plot sizes to suit your family's needs and preferences.

## Commercial Plots:

Elevate your business vision with our commercial plots that provide high visibility and accessibility. Ideal for shops, offices, or showrooms, these plots are set to become the new business hub of Lucknow.

## Location Advantage:

Situated near the Agra-Lucknow Expressway, Awadh Express City ensures seamless connectivity to major landmarks and quick access to the heart of the city.



# Prime Green City

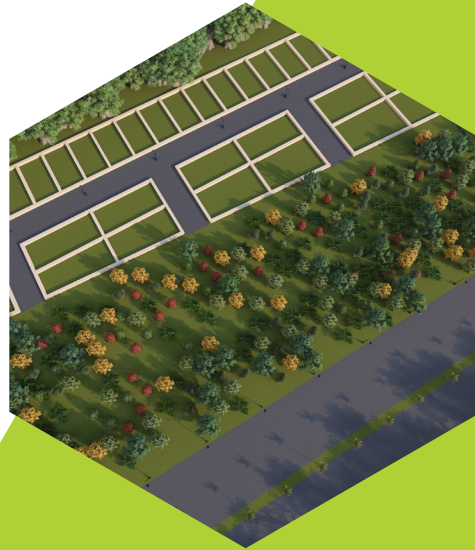

## Overview

Prime Green City beckons you to a life where greenery and modern infrastructure blend seamlessly to create an oasis of tranquility. Nestled adjacent to the serene SDRF colony near Bijnaur Sisendi Road in Lucknow, this prestigious project by JSI Infra Developers offers residential plots that are a perfect canvas for your dream home.

### Aminities



**01**  
Street Lights & Wide Roads



**02**  
Transformer



# Prime Green City Bijnaur

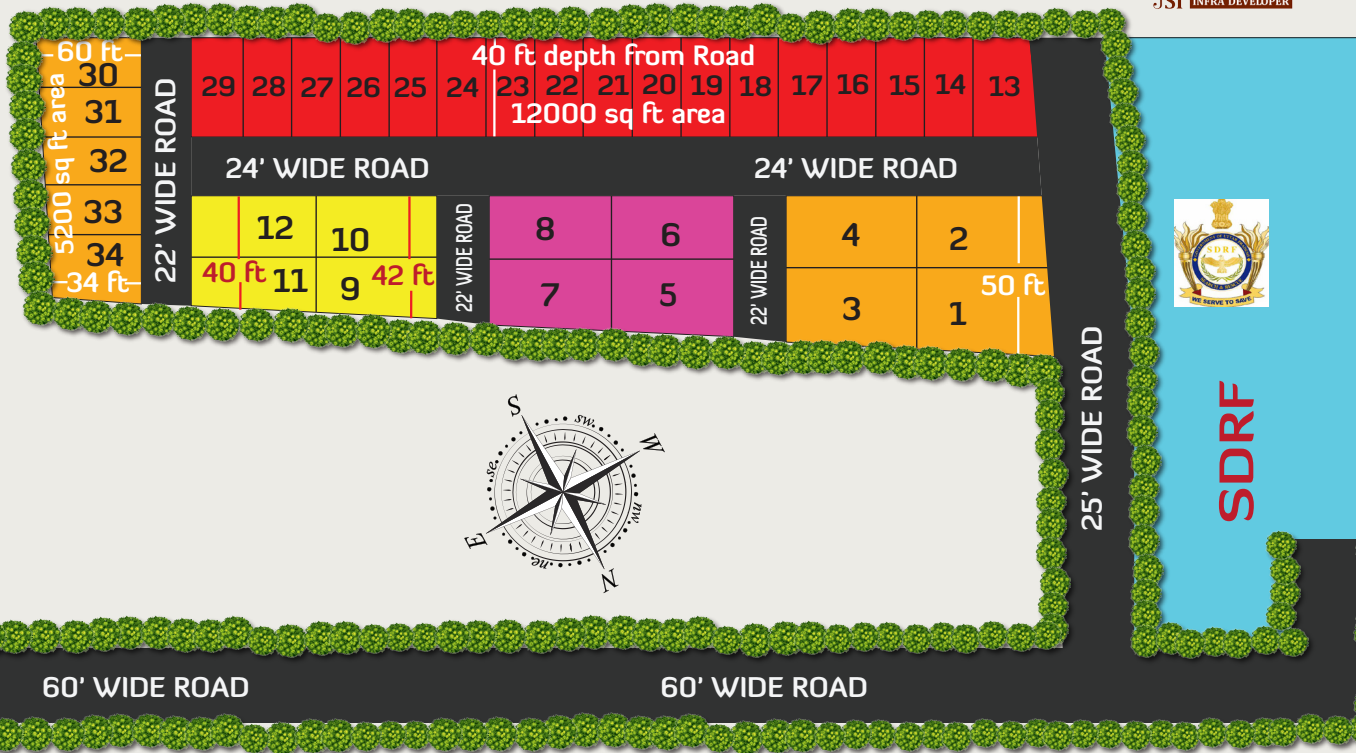

## Residential Plots:

With plots ranging from 30 to 60 ft in depth, Prime Green City provides ample space for your bespoke residence. The development boasts a 24 ft wide main road and 22 ft wide inner roads, ensuring smooth connectivity within the community.

## Facilities:

**Prime Location:** Nestled near the strategic SDRF, our township offers a blend of tranquility and connectivity.

**Investment Haven:** With the area's rapid development, investing here means securing your future.

## Location Advantage:

**Connectivity:** Easy access to major roads and public transport. Close to schools, hospitals, and shopping centers.



*First Floor, B-7,  
Shivay Tower,  
Sector-B, LDA  
Colony, Barabirwa  
Chauraha,  
Alambagh, Lucknow*

*Phone:  
info@jsiinfra.com*

*JSIINFRA.COM*